

Guiding cable for Venetian blinds

(supplied with wider venetian blinds)

- Close the blind completely to the bottom. Position the mounting bracket [1] with its opening directly below the slot in the bottom bar [2].

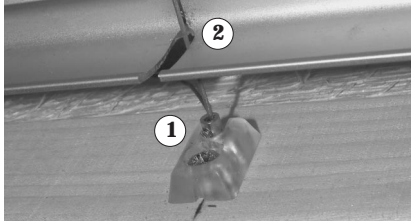

- Mark the position and fix in place.
- Put the locking ring onto the cable, holding the cable straight down, but without pulling it down.
- Tighten the locking ring 20mm above the sill.
- Pull the cable down and locate the locking ring under the mounting bracket.

OPERATION

1. Opening & Closing

- To open or close the blind push the bottom rail up or down until the desired position is reached. Products that are installed at high or inaccessible places can be operated with a detachable rod (optional). This rod locates into the bottom bar.

2. Tilting the slats

- The slats can be tilted by rotating the knob at the top right of the cassette. For blinds mounted at high level, the knob can be rotated with a rod (optional). The same rod connects to the bottom bar for raising and lowering.

3. Tilt-only Venetian blind

When you order a venetian blind with tilt-only option, this is a battery driven system that tilts the slats by remote control.

4. Battery replacement

(for tilt-only Venetian blinds)

The remote handset is fitted with three LR03, AAA batteries

- Remove the cover from the handset
- Remove the old batteries
- Replace with new batteries

The receiver, installed behind the valance of the cassette, is supplied with four LR6, AA batteries.

- Close the blind completely
- Push the slats carefully downwards
- Remove the old batteries
- Replace with new batteries

DEMOUNTING

To remove the product generally work in reverse to the previous instructions :

- Push the bottom rail completely upwards.
- If retained, push the transportation cleat back into the bottom rail.
- Pull the cord tensioners away from the side channels and tie off to transportation cleat.



- Unscrew and remove the side channels.
- Remove the cassette with the aid of a screwdriver.

Rollers, Duette® and Plissé Shades

Different fabrics have to be cleaned by different methods. Generally the products can be dusted with a feather duster or vacuumed on a low power setting. Some fabrics can be wiped with a damp cloth, avoiding excessive moisture. Avoid vigorously rubbing the fabrics as this can damage the fabric surface.

Venetian Blinds

The slats can be dusted with a feather duster or vacuumed on a low power setting. They can also be wiped with a damp cloth with a mild detergent.

CLEANING

These instructions have been prepared with care, but we will not be held responsible for any damage from cleaning.

Contact your Luxaflex® dealer for further advice.

Installation and Operating Instructions

Luxaflex® Roof Window Products



COMPONENTS SUPPLIED

Your package should contain:

- The Roof window blind in cassette.
- Two mounting brackets for cassette with two mounting screws per bracket.
- Two side channels with two-four screws per channel (depending on drop of blind).
- Two packaging side profiles (only supplied for window models with 100° or 105° angled frames).
- Two packaging side profiles (only supplied for window models with 100° or 105° angled frames).
- Fixing bracket and locking ring for tension cable supplied with wide Venetian blind models.

MOUNTING

Preparation for fixing

- Check that the position where you will be fixing the blind will not be subject to any obstructions such as handles or brackets.

Leave the blind in the closed position, do not remove transport cleat or stack tape yet!

Mounting cassette brackets

- Place the brackets into the recess until their upper lips sit flush against the window frame, this should be a minimum of 100mm from the side (1).
- Screw the brackets in place (2).
- Break off the upper lip by levering forward (3) (this can be done with a screwdriver).

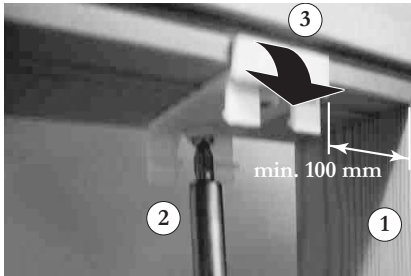

Installation of filling profiles (for 100° or 105° windows only).

- Place the filling profile with the lip against the frame (1).
- Fix the profiles with the screws (2).

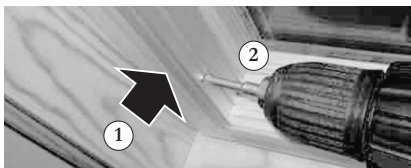

Installation of the cassette

- Take the cassette with both hands and push it into the brackets, the cassette will overlap the edge of the frame.

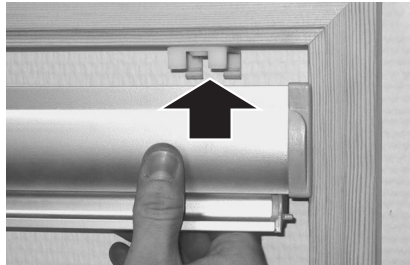

Installation of the side channels

- Push the side guides tight to the underside of the cassette.

Make sure that the end caps of the bottom rail locate into the side channels and that the cords will not be trapped between the channels and the frame.

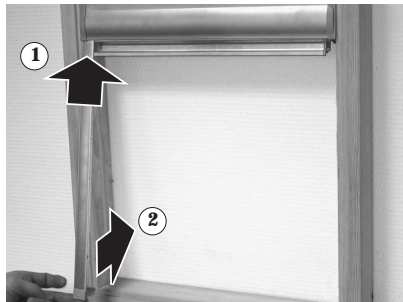

- Place the side channels against the frame.
- Screw into place using all screw holes (3).

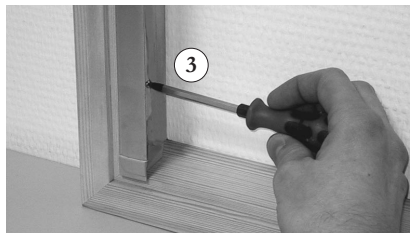

A Installation of cord tensioners

If you ordered a combi shade, go to (B)

- Remove the cords from the transportation cleat.

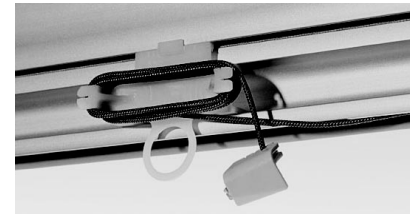

- Push the slat sides in the side channels up by a few cm (only Venetian blinds).



- Connect the cord tensioners to their holders on the bottom of the side channels.

Take care with Duette® & Pleated blinds that the cords do not become twisted.

- Remove the transport cleat (Roller, Duette®, and Pleated blinds).
- Remove the fastening tape from the stack (Venetian blinds).
- Open and close the product with the bottom bar to check that it is functioning correctly.

B Installation of Combi Shades with cord tensioners

- Place the pleated part with the lip into the opening of the side channel. First on one side (1), then repeat for the second side (2)



- Remove cords from the transport cleat.
- Connect both cords to the endcaps of the cassette.



- Push the upper rail of the pleated section until it clips into the bottom rail of the roller blind.

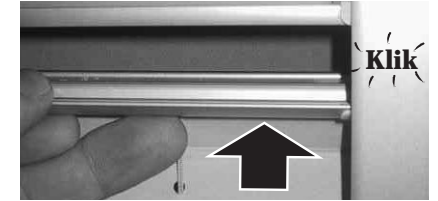

- Remove the cords from the transport cleat.

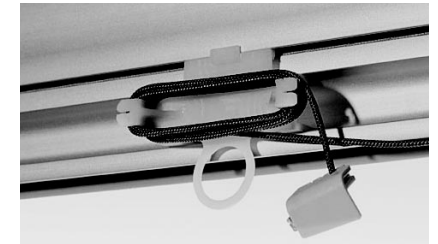

- Feed the cords through the holes of the cord tensioners.

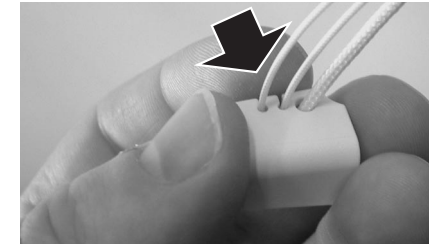

- Connect the cord tensioners to the bottom of the side channels.

Take care with Duette® & Pleated blinds that the cords do not become twisted.

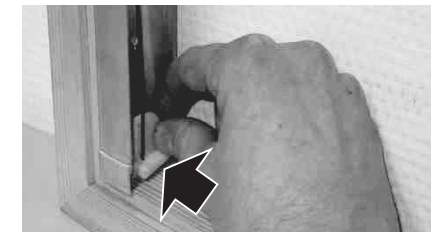

- Remove the transport cleat
- Open and close the product with the bottom bar to check that it is functioning correctly.