

MEASURING: WIDTH

12.0: Patio

How to measure a patio door

Measuring is done inside the recess, always measure in several places in front of your chosen L frame just in case the recess is at a slight angle.

Shutter type

Wooden shutters are best on large patio doors. Standard MDF shutters are heavy and not suitable for large openings.

Design

When the patio door is smaller than 2000mm wide 4 or 6 full height shutters would be suitable. Wider than this and Tposts or Track mounted shutters would be required.

Clearance

On larger doors, 6mm fitting clearance is allowed between each L frame side and the wall, this is called the shadow gap.

Use the template to choose the correct frame size depending on your louvre choice and how far the handle protrudes.

Width

Measure in 3 places across the width inside the recess in front of your selected L frame. (Use the smallest width.)

Skirting

Remove the skirting or cut out the frame around the skirting. Follow the '14.4 Skirting' cut out guide. Take the width above the skirting board when measuring.

Handles

Measure how far any handles protrude from the face of the door frame. Check this against the templates. See guide '1.3 Recess Protruding objects' for advice.

Front view of a patio door

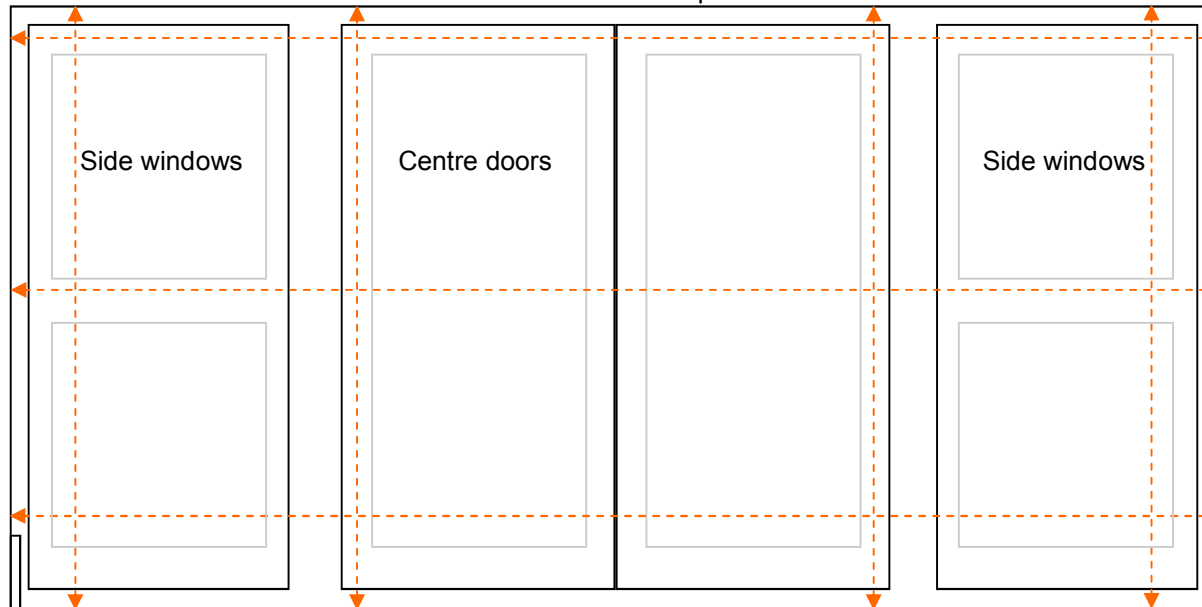

Plan View

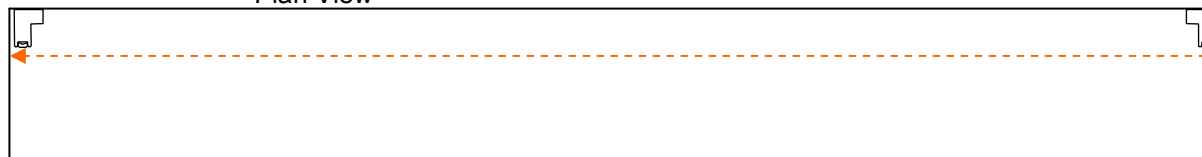

MEASURING: HEIGHT

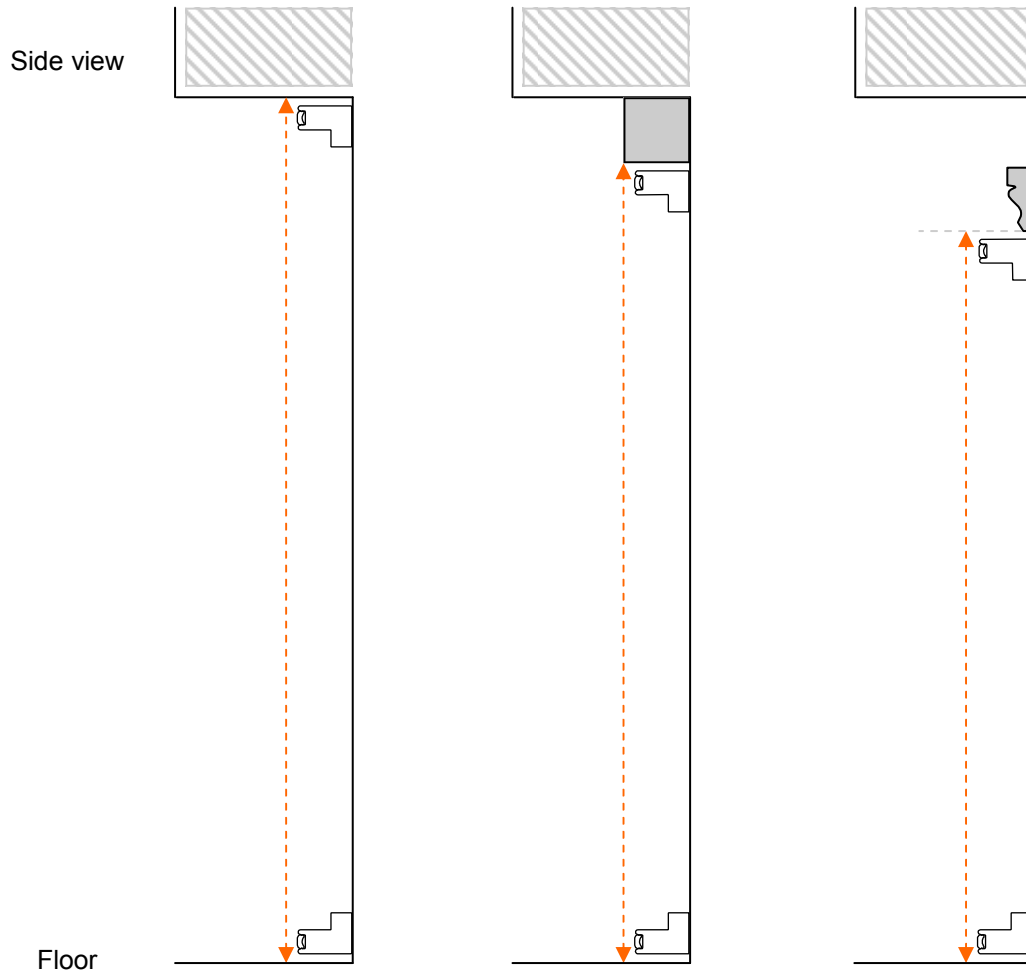

12.0: Patio

Measuring the height

3 examples of side views showing how frames can be finished at the top of a recess and where to measure for each type.

Clearance

6mm clearance is generally required top and bottom of the recess from any obstacles or architraves. For smaller windows 5mm clearance is enough.

Level

Remember to check the level and take the smallest height between the level points.

Measuring.

Measure from the floor to the inside of the top recess or architrave in 3 or 4 places and take the smallest height.

3 Sided frames

When there is no threshold at the bottom of the door, you can choose to have a 3 sided shutter frame to match.

3 sided frames sit flat on the floor, there will be a small 2.6mm clearance gap between the bottom of the frame and the bottom of the shutter to allow the shutters to open.

Take the height measurement from the floor as normal. When ordering 3 sided online, the relevant deductions will be made automatically when ordering recess size. When ordering frame size, you will only need to deduct 6mm from the top.

Door mats/uneven floors

Check the floor level when ordering 3 sided frames. The shutters will be at floor level so if the floor rises up it may stop the shutters from opening. Ordering longer side frames is one option, this will void the guarantee.

MEASURING: RAIL HEIGHTS

Front view of a patio door

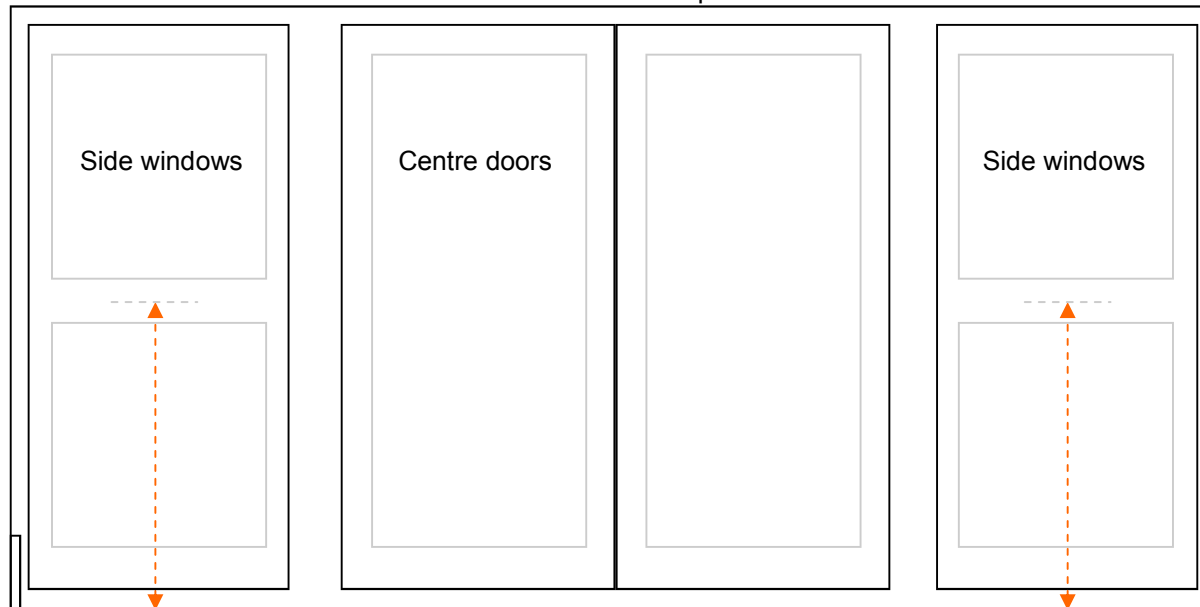

Plan View



12.0: Patio

Rail heights

Patio doors are normally only fitted with full height shutters, half height and top opening designs are not suitable.

Horizontal rail

Measure from the floor to the **centre** of the rail on the door or window.

Deduct 6mm when ordering 'Frame' size.

Heights over 1800mm require a horizontal rail as standard.

Void the guarantee

Some patio doors do not have any rails so it is possible to order your shutters without rails to match. This provides a modern clean look.

This will void the guarantee and it is not available in the Standard MDF range

Custom rail

It is possible to only have middle rails on the shutters that cover doors with rails on. Like in this typical example, the side windows have a central rail but the central doors do not.

Custom rails have an extra cost and are not available in the Standard MDF range.

Custom rails are wider than normal, but this ensures all the louvre blades line up either side of the rail.

Door handles

Lining up the rail with a handle can help prevent louvre blades catching on them. It might also help in ordering a smaller shutter frame if you are tight for room.

MEASURING: OUT OF LEVEL DOORS

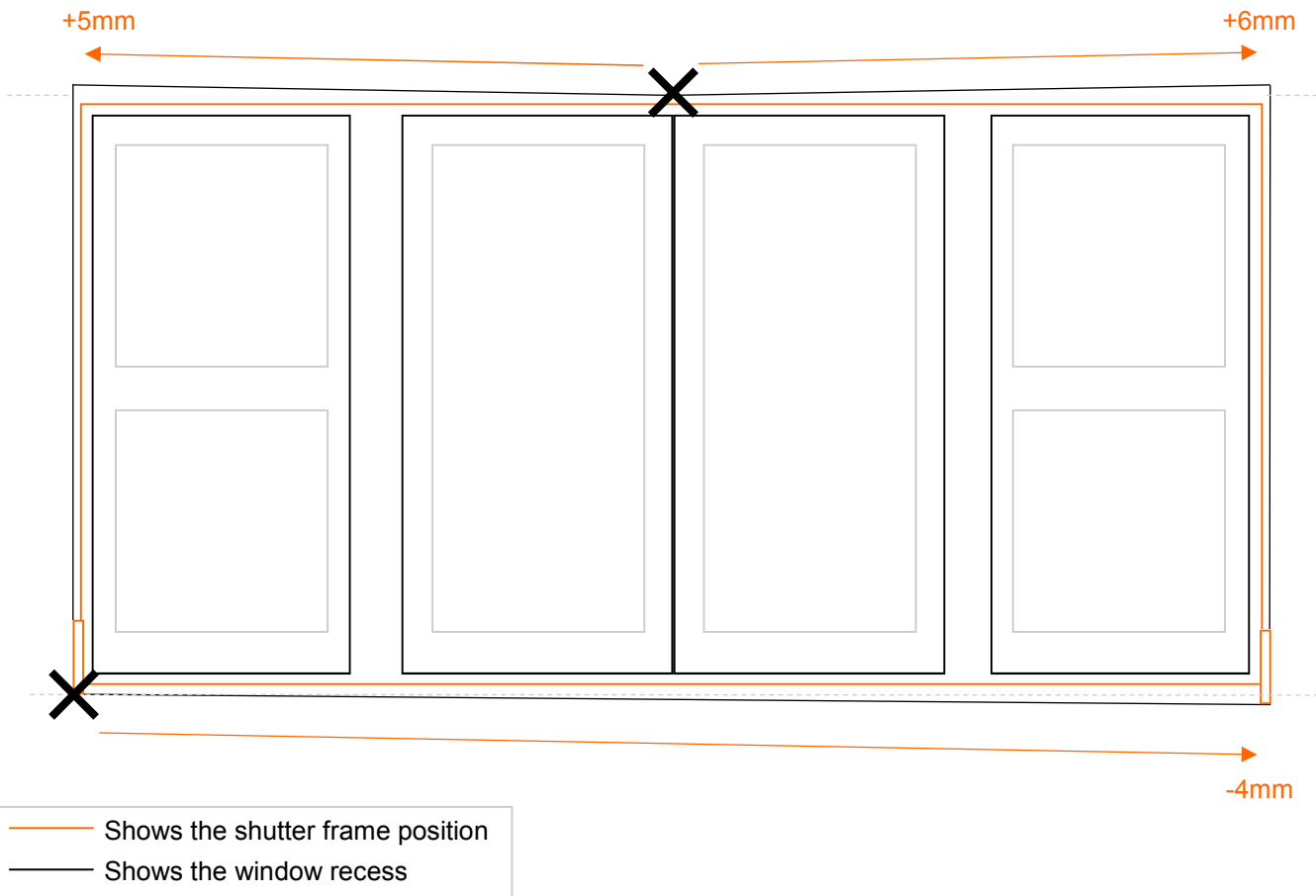

What if my door is out of level?

Sometimes doors can be out of level but still square. You can check how square the doors is by measuring across the diagonals.

Both measurements will be the same if the door is square. The shutter frame can be fitted to match the doorway, it does not have to be fitted level.

Example

In this example you can see the top gets lower in the centre and floor runs out to the right.

Although it should not happen, it is quite normal to find this when measuring.

The grey dotted lines indicate level lines, you will need to work out the smallest width and height from the levels you take, shown by the X's

This might be one reason you choose to order 'Frame' size rather than 'Recess' size. It allows you to create your own shadow gap according to the levels of your window.

Advice

If you would like further advice please upload photos of your door and a similar drawing with the relevant sizes and levels shown.

Shadow gap:

It is neater to leave a natural shadow gap than using filler. When the shutters and wall colouring are different shades of white or colour, any added filler (in another shade of white) can crack and look messy depending on the quality and how it is applied.

The shadow gap is the neatest natural alternative creating a professional finish, drawing your eye to the square shutter frame rather than the wonky door.

MEASURING: USING TPOSTS ON PATIO DOORS

12.0: Patio

Measuring a patio door with Tposts

Example

This drawing shows a typical patio door split into 4 sections, 2 side windows and opening doors in the centre.

Using Tposts will ensure the shutters match the door layout and provide easy access to the doors. The centre shutters can be folded right back against the side windows as they will be hinged on the Tposts.

No. shutters

This will depend on the width of the opening and each section. Typical examples would be - LTLRTR (4) or LLTLLRRTRR (8).

Measuring

From the left, measure to the centre of the 1st vertical upright (Mullion) on the door this will be your 1st Tpost width (T1).

Continue measuring from the left to the centre of all the uprights for the remaining Tposts you require.

Tposts

For more information on Tposts, please see the '1.4 Tpost' measuring guide.

Skirting

Remove the skirting or cut out the frame around the skirting. Follow the '14.4 Skirting' cut out guide.

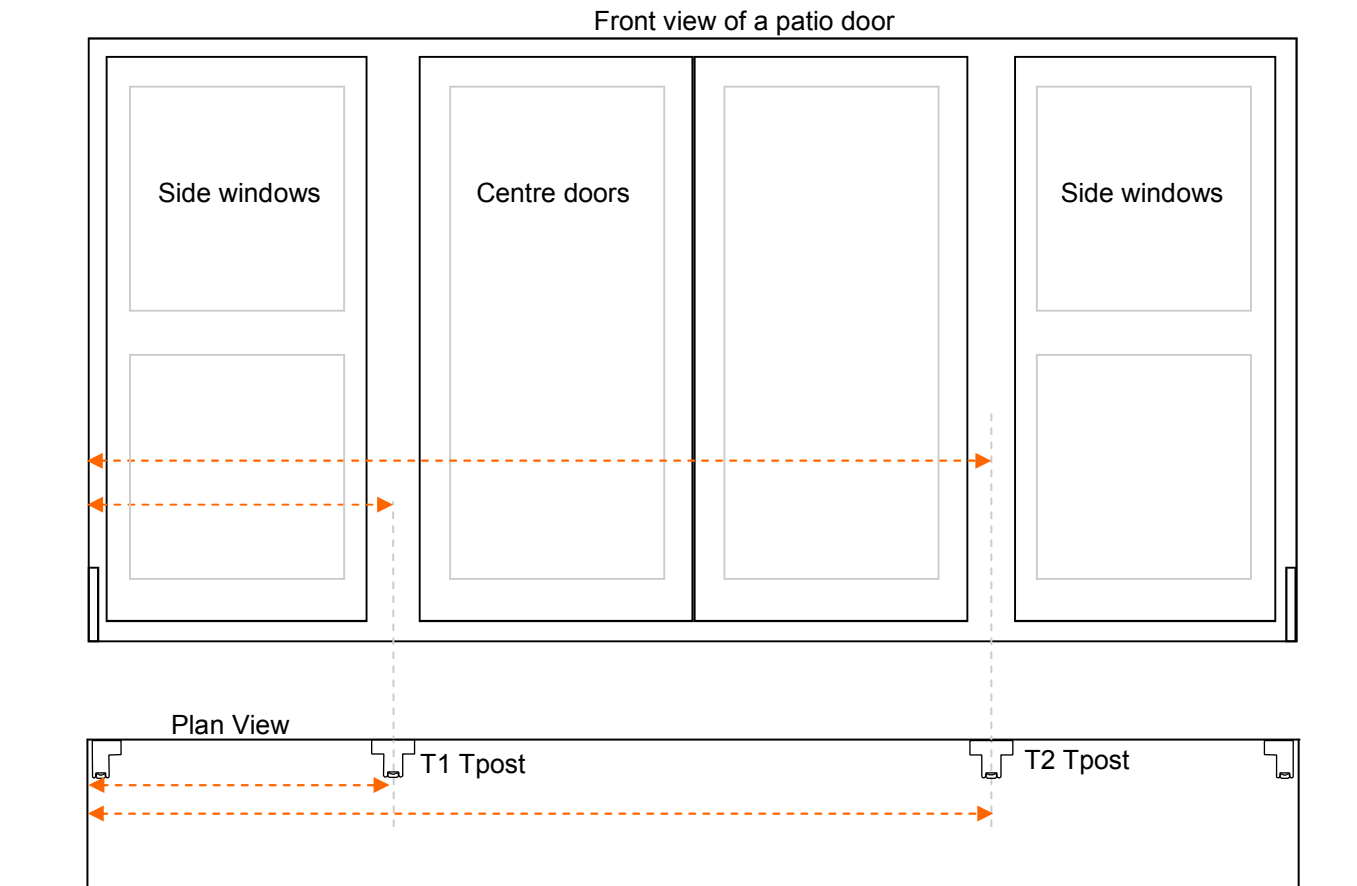

MEASURING: PARTIAL 4 SIDED FRAMES ON PATIO DOORS

Front view of a patio door

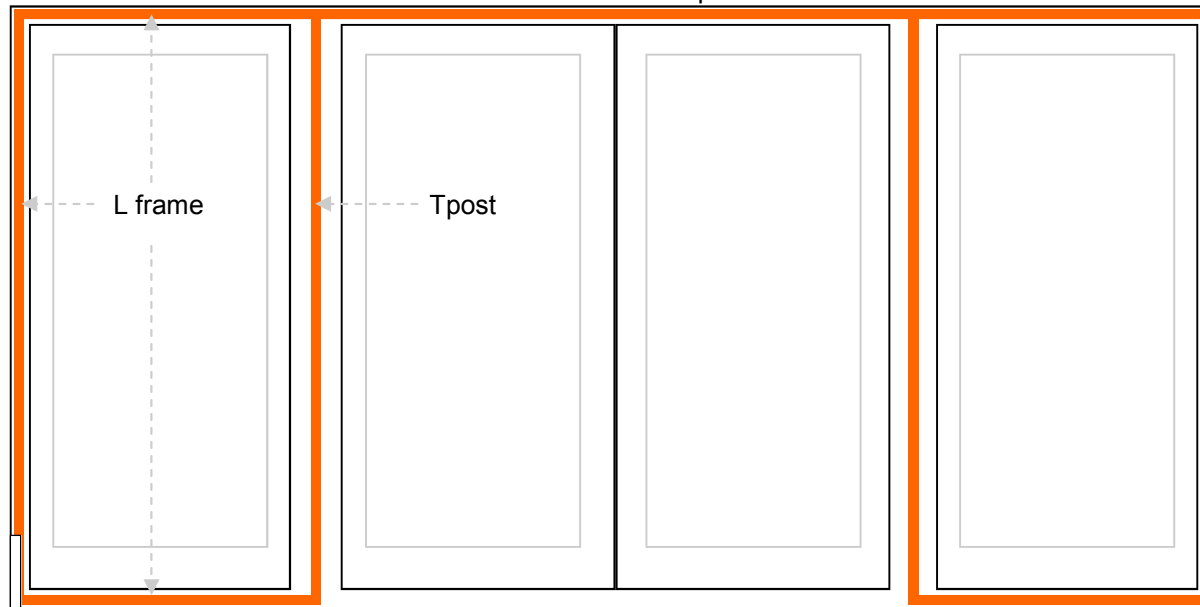

Plan View

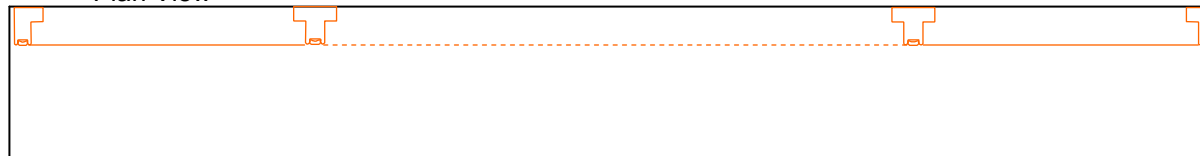

Partial 4 sided frame

When the centre doors have no threshold you can order a partial 4 sided frame.

This means there will be no bottom frame to trip over when walking through the door.

Battens

When fitting the frame on battens, extra Tpost support battens are recommended, as all of the weight of the large centre shutters will be on the two Tposts.

Ordering

This is not a standard feature and depending on size may void the guarantee.

Please request this option by using the notes box on the order form.

MEASURING: SURVEY FORM

12.0: Patio

Survey form

Enter your exact window recess sizes into the boxes on the left.

Enter the smallest recess order sizes below.

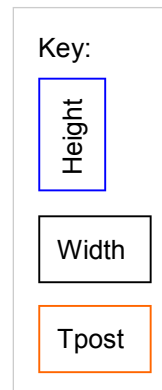
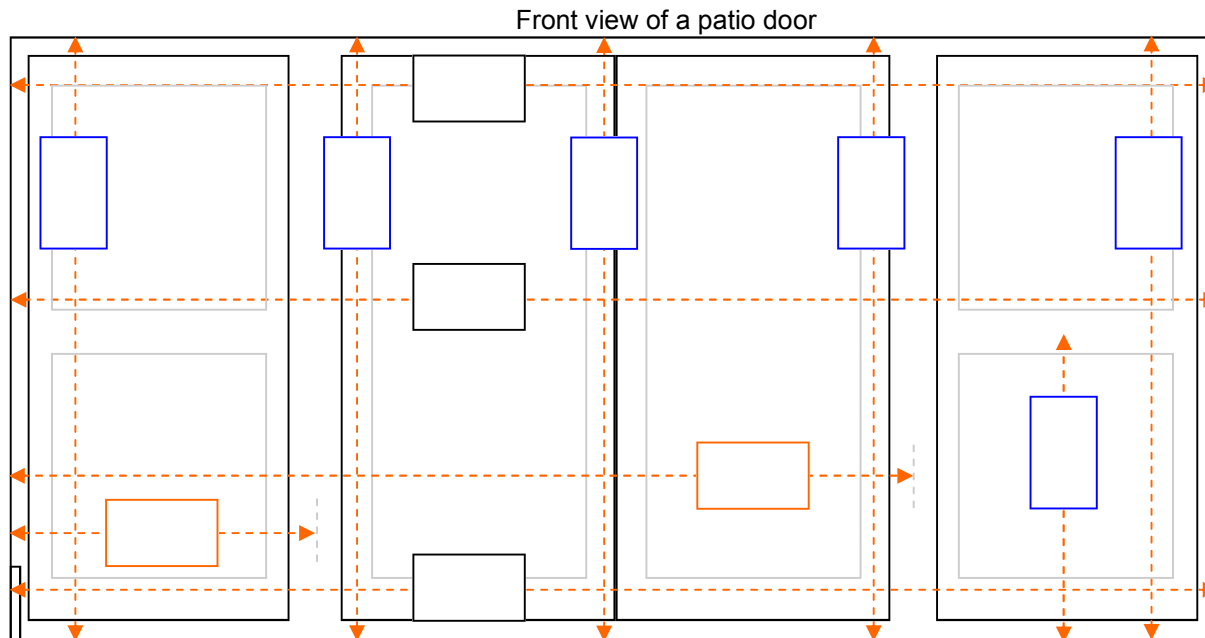

Shutter details	
Room name	
Shutter type	
Louvre size	
Colour	
Frame size	
Folding	
Options	

Smallest order sizes	
Width	
Height	
Horizontal Rail	
Handle	
Tpost 1	
Tpost 2	

'Double check your measuring'

Frame size

An important note about how frames are measured.

MEASURING: FRAME ORDER SIZE

Important:

All 'Frame' order sizes on L frames are taken from this highlighted edge.

